

## Dirt Separators

### Specification

Carbon steel body, flanged PN16, with stainless steel brush, vent plug and DN25 drain valve. For removal of dirt in closed HVAC heating water and cooling water systems.

**Not suitable for drinking water.**

### Materials

- Body Carbon steel
- Internals Stainless steel
- Flanges PN16, carbon steel

### Rating

10 Barg @ 110°C

Size	Length	Body size	Height	Stock code
in.	mm		mm	
DN050-2"	350	DN150	560	FEJD050
DN065-2½"	350	DN150	560	FEJD065
DN080-3"	460	DN200	710	FEJD080
DN100-4"	460	DN200	710	FEJD100
DN125-5"	630	DN250	980	FEJD125
DN150-6"	630	DN300	980	FEJD150

DN	DIM 'A'	DIM 'B'	DIM 'C'	DIM 'D'	DIM 'E'
50	165	350	350	560	125
65	165	350	350	560	125
80	219	460	500	710	200
100	219	460	500	710	200
125	273	630	770	980	335
150	324	630	770	980	335

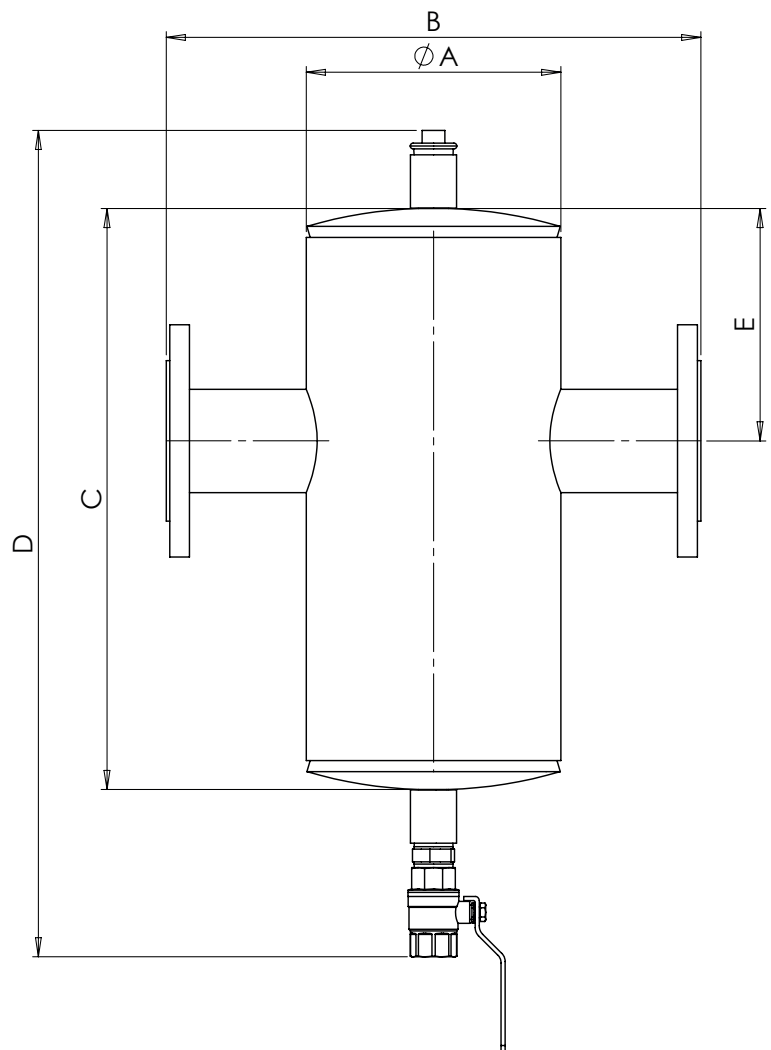

### Product by FlexEJ Ltd

For technical assistance & sales  
 t: +44 (0)1384 881188  
 e: sales@flexej.co.uk