

Low Loss Headers – Low Power DN20–DN25

Specification

Carbon steel body, BSPP female threaded system connections. Plugged air vent and drain connections.

A low loss header decouples the boiler from the system. This allows the boilers/boiler circuit flow to optimise at best efficiency for any system conditions. For closed HVAC heating systems.

Not suitable for drinking water.

Materials

- Body Carbon steel
- Internals –
- Connection BSPP female, carbon steel

Rating

6 Barg @ 110°C

The table shows performance for the FlexEJ Low Loss Headers with a 20°C temperature difference at a flow rate typical for the connection size.

Options

- Valves set including Flamco AAV and drain valve
- Insulation jacket (see page 27)
- Horizontal header – connection manifold (see page 28)

Size	Body size	Flow	Power	Product code
	DN mm	m ³ /h	kW	
DN20-3/4"	40	1.3	30	FEJLLH020BSP
DN25-1"	50	2	50	FEJLLH025BSP

DN	DIM 'A'	DIM 'B'	DIM 'C'	DIM 'D'	DIM 'E'	DIM 'F'	DIM 'G'	DIM 'H'	DIM 'I'	DIM 'J'
20	437	412	86	48	112	31	136	220	220	socket thread G3/4"
25	437	412	86	60	136	31	136	220	220	socket thread G1"

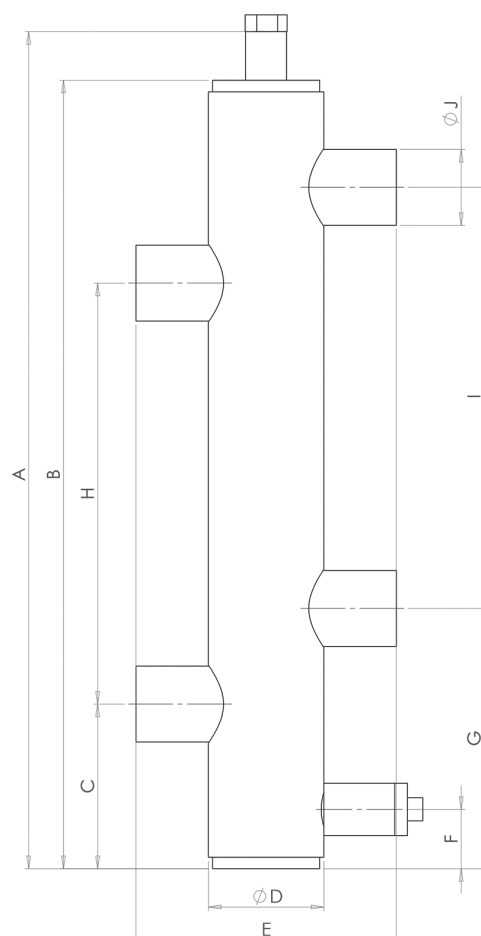

Product by FlexEJ Ltd

For technical assistance & sales
t: +44 (0)1384 881188
e: sales@flexej.co.uk

Low Loss Headers – Low Power DN32-DN50

Specification

Carbon steel body, BSPT male threaded system connections. Plugged air vent and drain connections. Brass thermocouple pocket and clip fitted in 1/2" socket.

A low loss header decouples the boiler from the system. This allows the boilers/boiler circuit flow to optimise at best efficiency for any system conditions. For closed HVAC heating systems.

Not suitable for drinking water.

Materials

- Body Carbon steel
- Internals –
- Connection BSPT male, carbon steel

Rating

6 Barg @ 110°C

The table shows performance for the FlexEJ Low Loss Headers with a 20°C temperature difference at a flow rate typical for the connection size.

Options

- Valves set including Flamco AAV and drain valve
- Insulation jacket (see page 27)
- Horizontal header – connection manifold (see page 28)

Size	Body size	Flow	Power	Product code
	DN mm	m³/h	kW	
DN32-R1¼"	65	3.0	70	FEJLLH032BSP
DN40-R1½"	80	4.7	110	FEJLLH040BSP
DN50-R2"	100	6.9	160	FEJLLH050BSP

DN	DIM 'A'	DIM 'B'	DIM 'C'	DIM 'D'	DIM 'E'	DIM 'F'	DIM 'G'	DIM 'H'	DIM 'I'	DIM 'J'
32	614	582	96	76	250	31	191	300	300	pipe thread R1¼"
40	614	582	96	88	270	31	191	300	300	pipe thread R1½"
50	614	582	96	114	300	31	191	300	300	pipe thread R2"

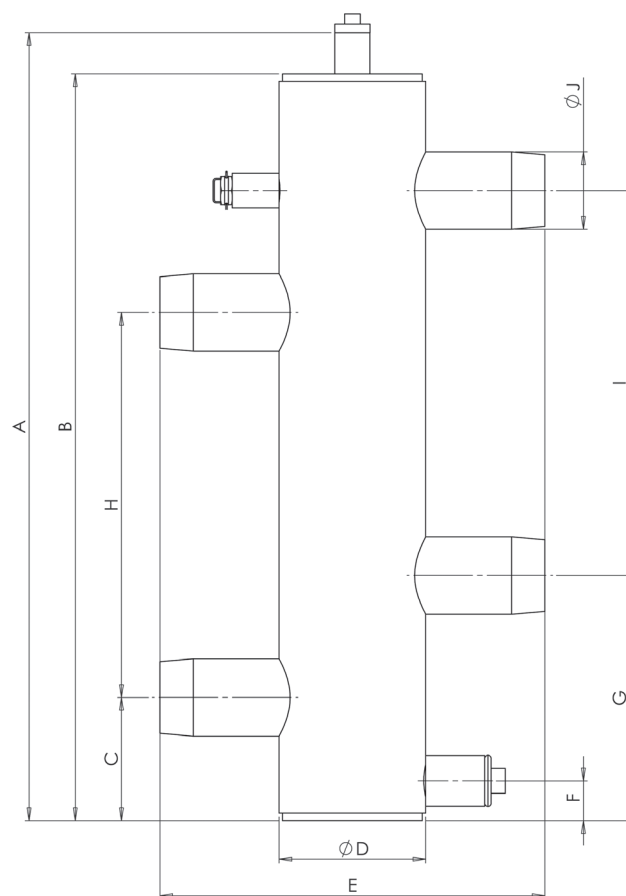

Product by FlexEJ Ltd

For technical assistance & sales
t: +44 (0)1384 881188
e: sales@flexej.co.uk

Low Loss Headers – Low Power DN65 PN6

Specification

Carbon steel body, DN65 PN6 flanged system connections. Plugged air vent and drain connections. Brass thermocouple pocket and clip fitted in 1/2" socket.

A low loss header decouples the boiler from the system. This allows the boilers/boiler circuit flow to optimise at best efficiency for any system conditions. For closed HVAC heating systems.

Not suitable for drinking water.

Materials

- Body Carbon steel
- Internals –
- Connection DN65 PN6 flange, carbon steel

Rating

6 Barg @ 110°C

The table shows performance for the FlexEJ Low Loss Headers with a 20°C temperature difference at a flow rate typical for the connection size.

Options

- Valves set including Flamco AAV and drain valve
- Insulation jacket (see page 27)

Size	Body size DN mm	Flow m³/h	Power kW	Product code
DN65-2½"	125	12.0	280	FEJLLH065PN6

DN	DIM 'A'	DIM 'B'	DIM 'C'	DIM 'D'	DIM 'E'	DIM 'F'	DIM 'G'	DIM 'H'	DIM 'I'	DIM 'J'
65	634	602	106	139	356	31	201	300	300	flange DN65, PN6

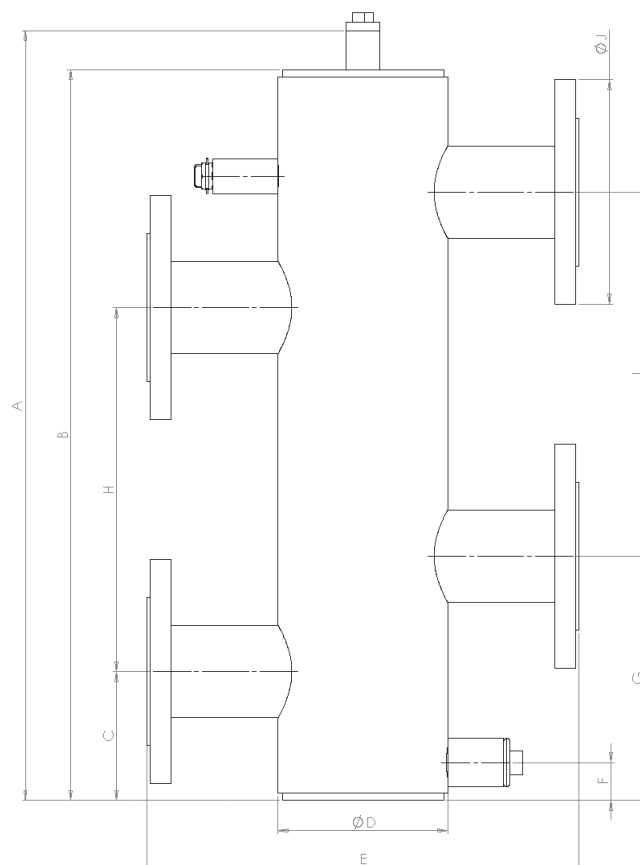

Product by FlexEJ Ltd

For technical assistance & sales
t: +44 (0)1384 881188
e: sales@flexej.co.uk

Low Loss Headers – Low Power
Insulation

Specification

Very flexible filled glass cloth insulation jacket with Velcro hook and loop flaps plus draw cords.

May be fitted to the Low Loss Header when all piping is complete and is easily removed / reinstalled for maintenance.

Materials

- Silicone coated 530 g/m2 e-glass cloth inner and outer, black
- Mineral rock fibre blanket filler 0.040 W/mK

Rating

110°C

Fire Classification: A1 to EN 13501-1

LLH Stock code	Insulation Stock code
FEJLLH020BSP	FEJLLH020BSPINS
FEJLLH025BSP	FEJLLH025BSPINS
FEJLLH032BSP	FEJLLH032BSPINS
FEJLLH040BSP	FEJLLH040BSPINS
FEJLLH050BSP	FEJLLH050BSPINS
FEJLLH065PN6	FEJLLH065PN6INS

Reduces heat loss by 90% in typical conditions



Product by FlexEJ Ltd

For technical assistance & sales
t: +44 (0)1384 881188
e: sales@flexej.co.uk

Low Loss Headers – Low Power Manifolds

Specification

Carbon steel pipe with BSPT male threaded system connections. Supplied with MAC Union (male for DN20 & DN25 and female for DN32 to DN50) for connection to the Low Loss Header, one header cap and one system cap.

Manifolds may be daisy chained to provide additional system connections.

Supplied as pairs.

Not suitable for drinking water.

Materials

- Pipe Carbon steel
- Internals –
- Connection BSPT male, carbon steel, pipe caps and union (male for DN20 & DN25 and female for DN32 to DN50) cast iron

Rating

6 Barg @ 110°C

DIM 'A'	DIM 'B'	DIM 'C'	DIM 'D'	DIM 'E'	DIM 'F'	DIM 'G'	DIM 'H'	DIM 'I'	Stock code
DN20	DN20	288	215	45	40	67	67	40	FEJMAN020BSP
DN25	DN20	350	270	50	51	84	84	51	FEJMAN025BSP
DN32	DN25	391	339	55	64	106	106	64	FEJMAN032BSP
DN40	DN25	452	386	58	73	121	121	73	FEJMAN040BSP
DN50	DN40	549	482	64	90	151	151	90	FEJMAN050BSP

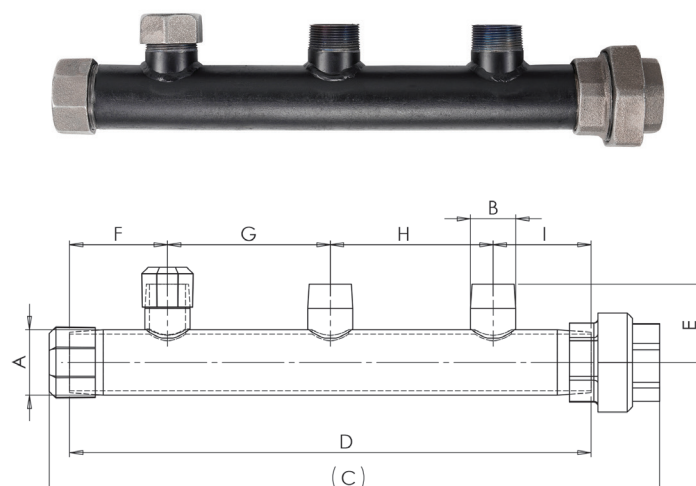
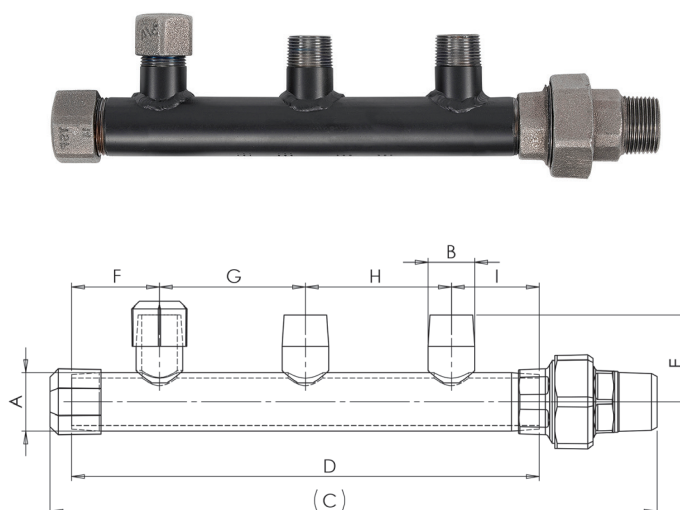
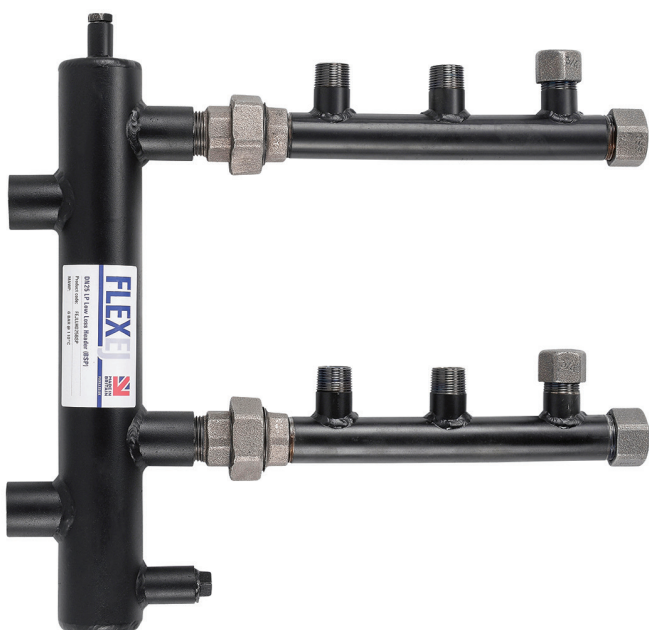

Product by FlexEJ Ltd

For technical assistance & sales
t: +44 (0)1384 881188
e: sales@flexej.co.uk